

Clutch

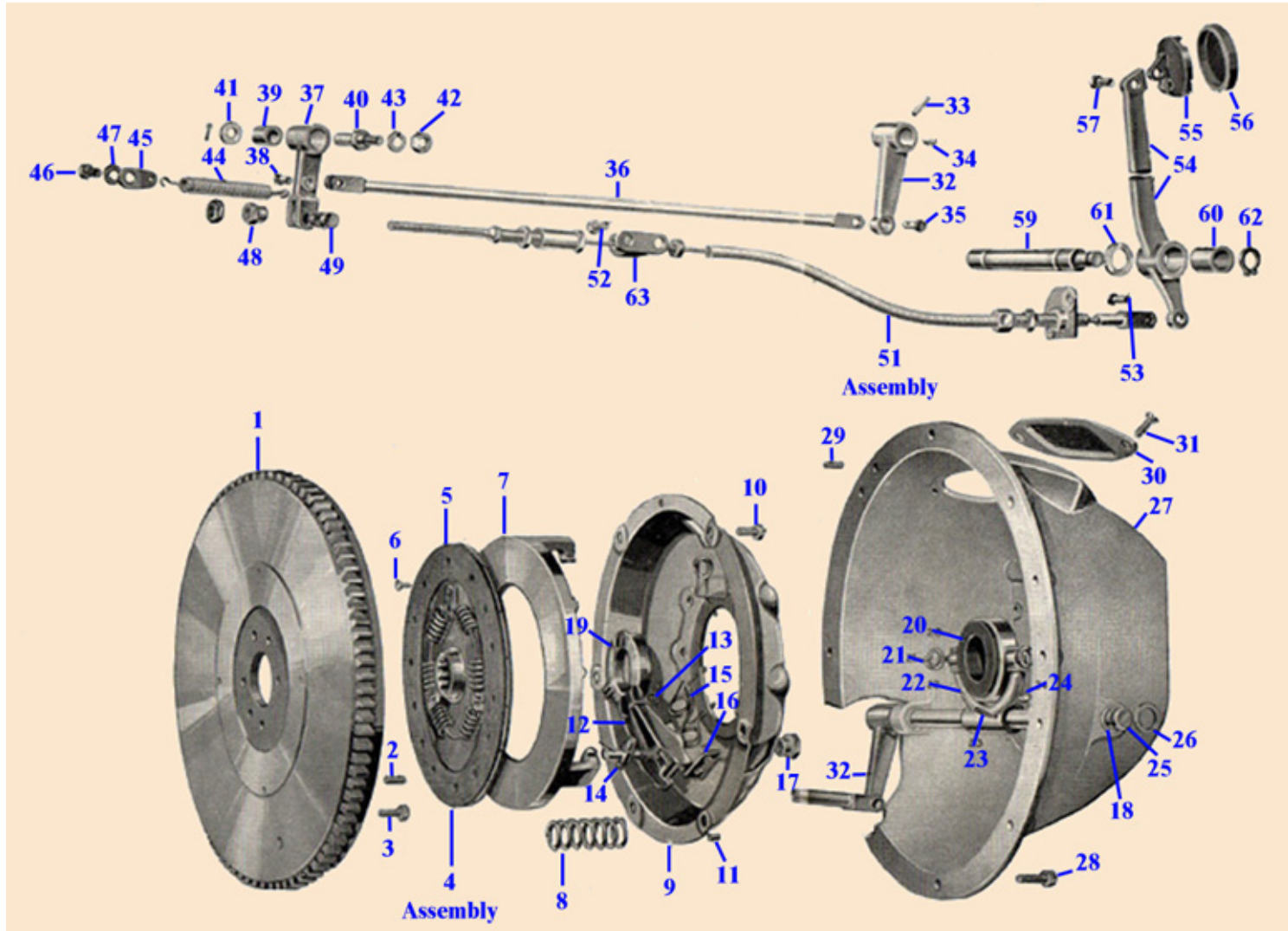

Ref #	Description * = suitable for unleaded head	Original Equipment MG Part Number	NTG Part Number	Moss Europe Part Number	Moss USA Part Number	Amount Required		
						YA	YT	YB
1	Flywheel (with starter ring and dowels) - see footnote.	MG862/11	D119T	-	-	1	1	-
		SA2252/1 from engine #14023	D119	-	-	-	-	1
	Starter ring - flywheel see footnote.		D118T	P163	190-020	1	1	-
		X24418 from engine #14023	D118TD	P164	190-030	-	-	1
2	Dowel for crankshaft	MG862/149	D119S	325-328 set	325-328 set	2	2	2
3	Bolt (flywheel securing)	MG679/152	D120D	320-524	320-524	4	4	4
4	Clutch driven plate assembly 7 1/4 inch	MG862/57	D010AX	GCP148	190-130	1	1	1
	Clutch driven plate assembly 8 inch	7H3215	D010BX	GCP132	190-140	1	1	1
5	Facing kit 7 1/4 inch	MG862/76	-	-	-	1	1	-
	Facing kit 8 inch	7H3216	-	-	-	-	-	1
6	Rivet for clutch driven plate	MG862/350	-	-	-	14	14	14
7	Clutch pressure plate 7 1/4 inch clutch	MG862/291	D013AX assembly	22A67	190-840	1	1	1
	Clutch pressure plate 8 inch clutch	7H3085	D013BX assembly	GCC108	190-120	1	1	1
8	Clutch spring	MG862/290	-	-	-	6	6	6
9	Clutch cover	MG862/280	-	-	-	1	1	1
10	Bolt for clutch cover	X151/19	D026B	320-260	320-260	6	6	6
11	Dowel for clutch cover	MG795/140	-	-	-	2	2	2

Ref #	Description * = suitable for unleaded head	Original Equipment MG Part Number	NTG Part Number	Moss Europe Part Number	Moss USA Part Number	Amount Required		
						YA	YT	YB
12	Clutch release lever	MG862/281	-	-	-	3	3	3
13	Retaining springs for release lever	MG862/288	-	-	-	3	3	3
14	Fulcrum pin for release lever	MG862/285	-	-	-	3	3	3
15	Anti rattle spring for release lever	MG862/287	-	-	-	3	3	3
16	Strut for release lever	MG862/286	-	-	-	3	3	3
17	Eyebolt and nut complete	MG862/78	-	-	-	3	3	3
18	Bush 5/8 inch shaft	MG862/335	D032F	330-070	330-070	2	2	-
	Bush 3/4 inch	X20268	D032G	330-060	330-060	-	-	2
19	Release lever plate	MG862/289	-	-	-	1	1	1
20	Clutch release bearing and cup assembly	MG795/14	D012	GRB103	190-290	1	1	1
21	Retainer for clutch release bearing	MG795/161	D033	7H3048	190-310	2	2	2
22	Clutch fork 5/8 inch shaft	MG862/300	-	190-340	190-340	1	1	-
	Clutch fork 3/4 inch shaft			190-350	190-350	-	-	1
23	Taper pin for clutch fork	X706/4	D034	-	-	1	1	1
24	Key for clutch fork 5/8 inch shaft	P151/185	B262	327-050	327-050	1	1	-
	Key for clutch fork 3/4 inch shaft			WKN606	327-070	-	-	1
25	Clutch withdrawal shaft 5/8 inch shaft	MG917/117	D032B	190-320	190-320	1	1	-
	Clutch withdrawal shaft 3/4 inch shaft	168023	D032C	190-330	190-330	-	-	1
26	Circlip 5/8 inch shaft	MG862/456	-	326-030	326-030	1	1	-
	Circlip 3/4 inch shaft			326-140	326-140	-	-	1
27	Clutch housing (with bushes) 7 1/4 inch clutch	MG900/14	D038T	-	-	1	1	-

Ref #	Description * = suitable for unleaded head	Original Equipment MG Part Number	NTG Part Number	Moss Europe Part Number	Moss USA Part Number	Amount Required		
						YA	YT	YB
	Clutch housing (with bushes) 8 inch clutch	SA2437/1	D038F	-	-	-	-	1
28	Bolt for clutch housing	P151/151	B244F	321-058 set	321-058 set	10	10	10
29	Dowel for clutch housing	MG862/324	-	-	-	2	2	2
30	Inspection cover	MG795/148	D039	-	-	1	1	1
31	Screw	MG706/240	D039A	-	-	2	2	2
32	Clutch operating lever 5/8 inch shaft	MG900/146	D040B	190-370	190-370	1	1	-
	Clutch operating lever 3/4 inch	168021	D040C	190-380	190-380	-	-	1
33	Taper pin for clutch operating lever	X706/4	D034	325-020	325-020	1	1	1
34	Key for clutch operating lever	P151/185	B262	327-050	327-050	1	1	1
35	Pin for clutch lever	S47/19	D037	2K6930		1	1	1
36	Connecting rod for clutch	S64/20	D036	190-420	190-420			
37	Lever for cable and connecting rod	MG900/27	D031	190-400	190-400	1	1	1
38	Yoke pin	S47/17	D037	2K6930	327-050			
39	Bush	MG679/473	D031B	330-010	330-010	1	1	1
40	Fulcrum pin for lever	MG900/151	D030	190-390	190-390	1	1	1
41	Washer for fulcrum pin	MG900/155	-	324-560	324-560	1	1	1
42	Nut	MG900/152	F105	AJD8336Z	311-240	1	1	1
43	Washer	MG900/153	-	-	-	1	1	1
44	Spring for clutch return	S73/16	D035	329-330	329-330	1	1	1
45	Bracket for clutch return spring	S44/174	D036	190-410	190-410	1	1	1

Ref #	Description * = suitable for unleaded head	Original Equipment MG Part Number	NTG Part Number	Moss Europe Part Number	Moss USA Part Number	Amount Required		
						YA	YT	YB
46	Bolt for bracket	MG900/265	-	-	-	1	1	1
47	Spring washer for bolt	MG862/148	-	-	-	1	1	1
48	Nut for clutch adjuster	S105/8	D027A	190-430	190-430	1	1	1
49	Pin for clutch adjuster	S47/16	D031A	190-440	190-440	1	1	1
50	Intentionally left blank							
51	Clutch cable assembly	S96/6	D026	331-070	331-070	1	1	1
52	Bolt for bracket	MG900/147	D026B	-	-	1	1	1
53	Pin for clutch pedal	S47/19	D037	2K6930	327-050	1	1	1
54	Clutch pedal arm with bush	MG898/101	S796B RHD	406-720	406-720	1	1	1
			S796C LHD	-	-			
55	Clutch pedal pad	S45/13	-	406-750	406-750	1	1	1
56	Pedal rubber	S68/48	R066	ACA5359	281-278 set	2	2	2
57	Pinch bolt for brake pedal	S33/91	-	-	-	1	1	1
59	Shaft for pedals	S90/5	D506Y	-	-	1	1	1
60	Bush	MG898/101	D506L	-	-	1	1	1
61	Spacing washer	S98/34	-	324-430	324-430	1	1	1
62	Circlip for clutch pedal shaft	S40/6	-	326-050	326-050	1	1	1
63	Abutment bracket for clutch cable	MG900/156	D026A	190-590	190-590	1	1	1

Flywheel ring variants.

	NTG Part Number	Moss Europe Part Number	Moss USA Part Number
93 teeth 7 1/4 inch clutch plate	D118T	-	-
120 teeth 7 1/4 inch clutch plate	D118TD	-	-